

WRAPTOR TP 1650 H:3000

WINDOWS - DOORS - PALLETS - BOXES



PRE-STRETCH SYSTEM



MECHANICAL BRAKE SYSTEM

Ask for details

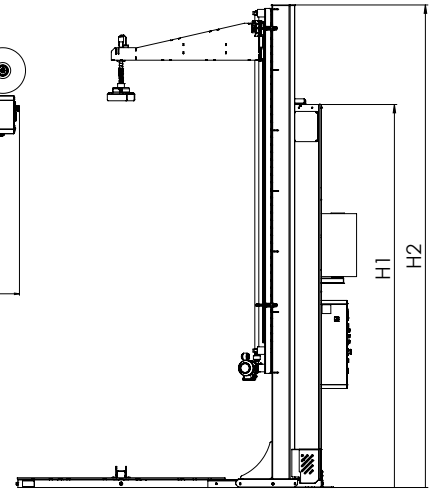
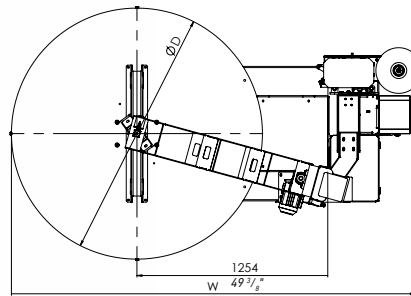

VERTICAL STRETCH FILM SERIES

TECHNICAL FEATURES

MACHINE GENERAL FEATURES

Table Diameter	mm/inch
Table Turning Speed	rpm
Forklift Lifting Place	
*Electric Supply	Volt - Hz
Total Power	kW
Tensioning System	
Tensioning Rate	[%]
Speed Adjustment	

WRAPTOR TP 1650 MB 3000

Table Diameter	mm/inch	Ø1650	64 ⁶¹ / ₆₄ "
Table Turning Speed	rpm	2 - 10	
Forklift Lifting Place		Front	
*Electric Supply	Volt - Hz	220 Volt - 50/60 Hz Monophase	
Total Power	kW	1	
Tensioning System		Mechanical Brake	
Tensioning Rate	[%]	0 - 100	
Speed Adjustment		Available	

WRAPTOR TP 1650 VPT 3000

Table Diameter	mm/inch	Ø1650	64 ⁶¹ / ₆₄ "
Table Turning Speed	rpm	2 - 10	
Forklift Lifting Place		Front	
*Electric Supply	Volt - Hz	220 Volt - 50/60 Hz Monophase	
Total Power	kW	1,2	
Tensioning System		Motorized Pre-Stretching	
Tensioning Rate	[%]	0 - 250	
Speed Adjustment		Available	

* 110 Volt 50/60 Hz Monophase (optional)

FILM ROLL FEATURES

Film Width	mm/inch	200 - 500	7 ⁷ / ₈ " - 19 ¹¹ / ₁₆ "	500	19 ¹¹ / ₁₆ "
Max. Roll Diameter	mm/inch	Ø250	9 ²⁷ / ₃₂ "	Ø250	9 ²⁷ / ₃₂ "
Max. Roll Weight	kg	16		16	
Roll Inner Diameter	mm/inch	Ø76	2 ⁶³ / ₆₄ "	Ø76	2 ⁶³ / ₆₄ "

PACKAGING PRODUCT DIMENSIONS

Max. Dimensions (W x D)	mm/inch	1300 x 1100	51 ³ / ₁₆ " x 43 ⁵ / ₁₆ "	1300 x 1100	51 ³ / ₁₆ " x 43 ⁵ / ₁₆ "
Max. Height	mm/inch	3000	118 ⁷ / ₆₄ "	3000	118 ⁷ / ₆₄ "
Loading Capacity	kg	2000		2000	

MACHINE DIMENSIONS

Height	mm/inch	3835	150 ⁶³ / ₆₄ "	3835	150 ⁶³ / ₆₄ "
Width	mm/inch	1650	64 ⁶¹ / ₆₄ "	1650	64 ⁶¹ / ₆₄ "
Depth	mm/inch	2660	104 ²³ / ₃₂ "	2660	104 ²³ / ₃₂ "

